

STAGE 1 - TEMPORARY TRAFFIC SIGNAGE DETAIL 'A'

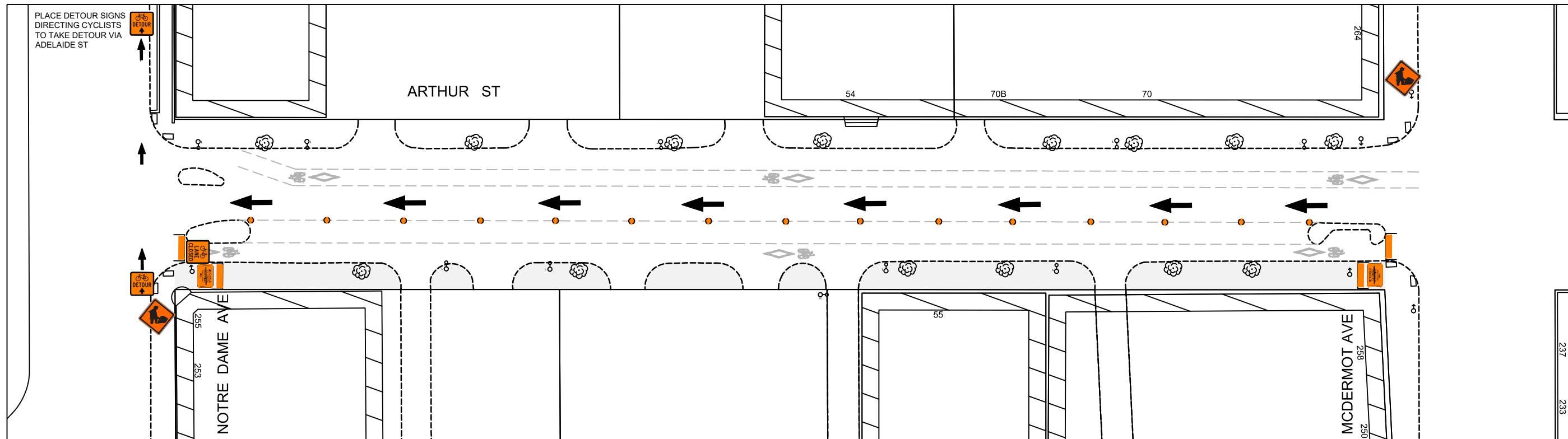

TRAFFIC SIGNAGE & STAGING

TC-2 ROADWORK		TRAFFIC LANE DIRECTION	
CHEVRON LEFT/RIGHT		POLY POST	
RB 11 (L/R) TURN PROHIBITED		C-46 SIDEWALK CLOSED	
RB 25(L) KEEP LEFT/RIGHT		TC-68 BIKE LANE CLOSED	
BARRICADE		TC-70 BIKE DETOUR	
CHANNELIZATION BARREL		TC-5R RIGHT LANE ENDS	

NOTES:

1. ALL TRAFFIC SIGNAGE AND TEMPORARY TRAFFIC CONTROL TO CONFORM WITH THE LATEST REVISION OF THE CITY OF WINNIPEG MANUAL OF TEMPORARY TRAFFIC CONTROL ON CITY STREETS
2. ONE LANE MUST REMAIN OPEN DURING CONSTRUCTION
3. PEDESTRIAN CORRIDOR MUST BE MAINTAINED IN THE CURB LANES DURING CONSTRUCTION IF THE SIDEWALK HAS BEEN REMOVED, AND THERE MUST BE ACCESS PROVIDED TO ALL RESIDENCES AND BUSINESSES
4. PARKING TO BE REMOVED AT TIME OF CONSTRUCTION.
5. CONTRACTOR SHALL MAINTAIN SAFE PEDESTRIAN ACCESS AND CROSSINGS. WHERE SIDEWALKS ARE LOCATED ON BOTH SIDES OF THE STREET, CONTRACTOR MUST MAINTAIN PEDESTRIAN ACCESS ON ONE SIDE AT ALL TIMES.
6. TC-2 ROADWORK SIGNAGE TO BE PLACED 50.0m IN ADVANCE OF CONSTRUCTION.

CONSTRUCTION AREA:

FOR INFORMATION ONLY

TENDER NO. 11-2023



THE CITY OF WINNIPEG  
PUBLIC WORKS DEPARTMENT

ARTHUR ST  
FROM NOTRE DAME AVE TO McDERMOT AVE  
TEMPORARY TRAFFIC SIGNAGE

ENGINEERING DIVISION  
TECHNOLOGY SERVICES BRANCH  
106 - 1155 PACIFIC AVE

STAGE 2 - TEMPORARY TRAFFIC SIGNAGE DETAIL 'A'

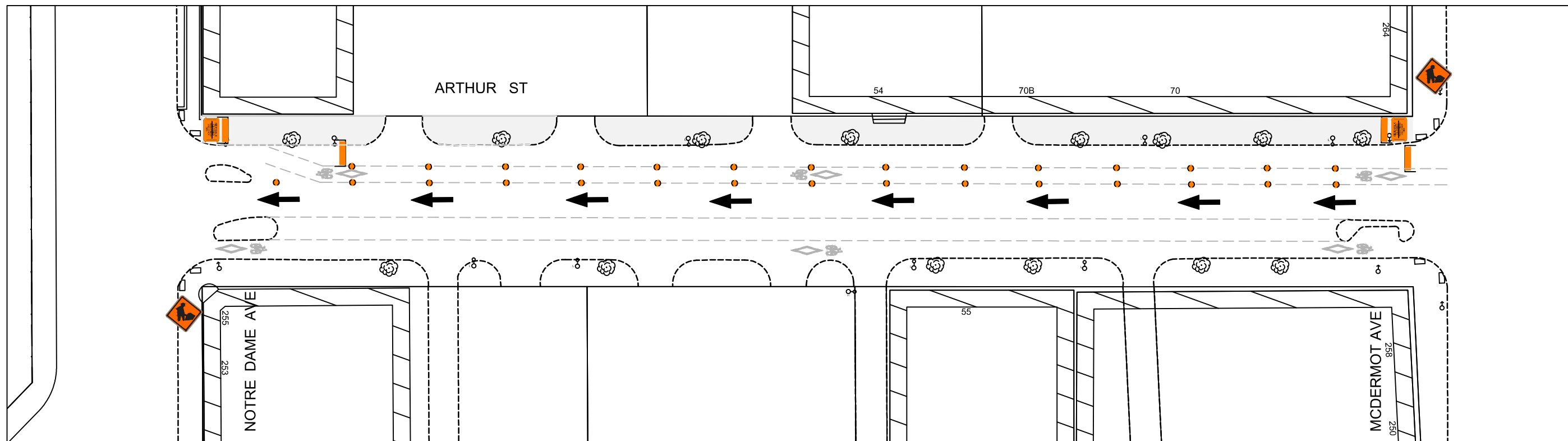

TRAFFIC SIGNAGE & STAGING

- TC-2 ROADWORK
- CHEVRON LEFT/RIGHT
- RB 11 (L/R) TURN PROHIBITED
- RB 25(L) KEEP LEFT/RIGHT
- BARRICADE
- CHANNELIZATION BARREL



- TRAFFIC LANE DIRECTION
- POLY POST
- C-46 SIDEWALK CLOSED
- TC-68 BIKE LANE CLOSED
- TC-70 BIKE DETOUR
- TC-5R RIGHT LANE ENDS



NOTES:

1. ALL TRAFFIC SIGNAGE AND TEMPORARY TRAFFIC CONTROL TO CONFORM WITH THE LATEST REVISION OF THE CITY OF WINNIPEG MANUAL OF TEMPORARY TRAFFIC CONTROL ON CITY STREETS
2. ONE LANE MUST REMAIN OPEN DURING CONSTRUCTION
3. PEDESTRIAN CORRIDOR MUST BE MAINTAINED IN THE CURB LANES DURING CONSTRUCTION IF THE SIDEWALK HAS BEEN REMOVED, AND THERE MUST BE ACCESS PROVIDED TO ALL RESIDENCES AND BUSINESSES
4. PARKING TO BE REMOVED AT TIME OF CONSTRUCTION.
5. CONTRACTOR SHALL MAINTAIN SAFE PEDESTRIAN ACCESS AND CROSSINGS. WHERE SIDEWALKS ARE LOCATED ON BOTH SIDES OF THE STREET, CONTRACTOR MUST MAINTAIN PEDESTRIAN ACCESS ON ONE SIDE AT ALL TIMES.
6. TC-2 ROADWORK SIGNAGE TO BE PLACED 50.0m IN ADVANCE OF CONSTRUCTION.

CONSTRUCTION AREA:

FOR INFORMATION ONLY

TENDER NO. 11-2023



THE CITY OF WINNIPEG  
PUBLIC WORKS DEPARTMENT

ARTHUR ST  
FROM NOTRE DAME AVE TO McDERMOT AVE  
TEMPORARY TRAFFIC SIGNAGE

ENGINEERING DIVISION  
TECHNOLOGY SERVICES BRANCH  
106 - 1155 PACIFIC AVE

TEMPORARY TRAFFIC SIGNAGE DETAIL 'A'

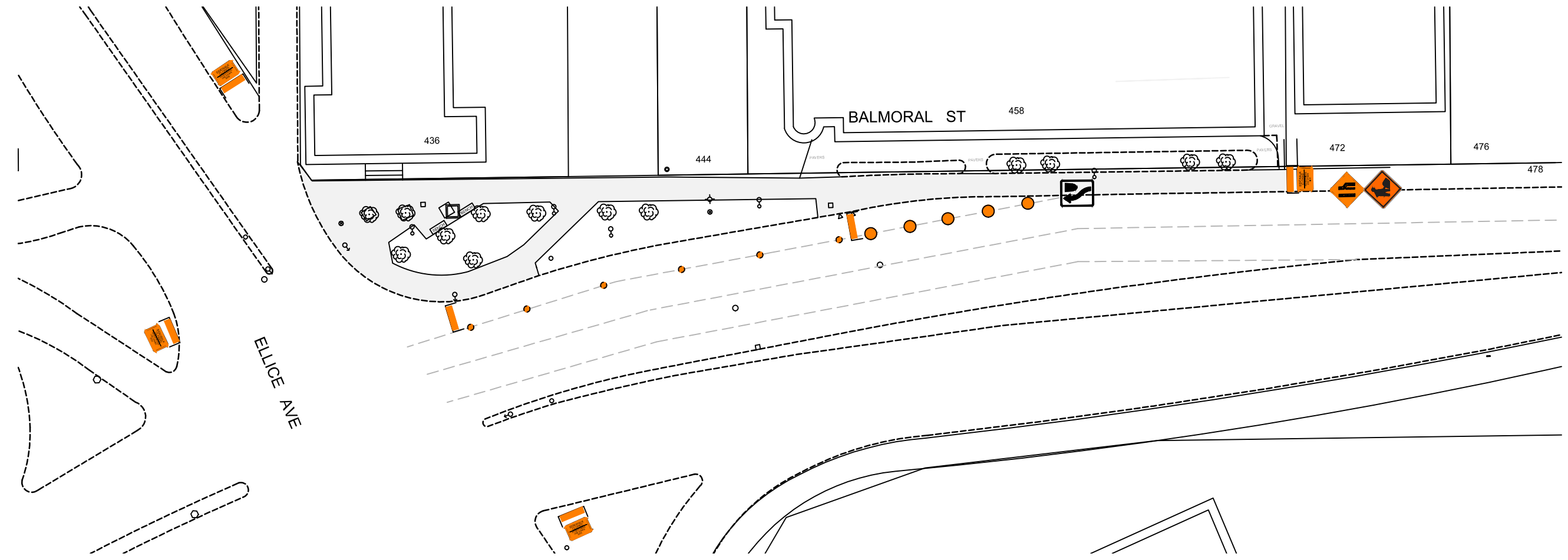
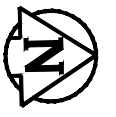

TRAFFIC SIGNAGE & STAGING

- TC-2 ROADWORK
- CHEVRON LEFT/RIGHT
- RB 11 (L/R) TURN PROHIBITED
- RB 25(L) KEEP LEFT/RIGHT
- BARRICADE
- CHANNELIZATION BARREL

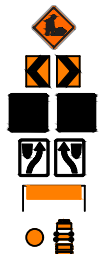

- TRAFFIC LANE DIRECTION
- POLY POST
- YIELD TO ONCOMING TRAFFIC
- C-46 SIDEWALK CLOSED
- FLAGMAN
- TC-5R RIGHT LANE ENDS



NOTES:

1. ALL TRAFFIC SIGNAGE AND TEMPORARY TRAFFIC CONTROL TO CONFORM WITH THE LATEST REVISION OF THE CITY OF WINNIPEG MANUAL OF TEMPORARY TRAFFIC CONTROL ON CITY STREETS
2. ONE LANE MUST REMAIN OPEN DURING CONSTRUCTION
3. PEDESTRIAN CORRIDOR MUST BE MAINTAINED IN THE CURB LANES DURING CONSTRUCTION IF THE SIDEWALK HAS BEEN REMOVED, AND THERE MUST BE ACCESS PROVIDED TO ALL RESIDENCES AND BUSINESSES
4. PARKING TO BE REMOVED AT TIME OF CONSTRUCTION.
5. CONTRACTOR SHALL MAINTAIN SAFE PEDESTRIAN ACCESS AND CROSSINGS. WHERE SIDEWALKS ARE LOCATED ON BOTH SIDES OF THE STREET, CONTRACTOR MUST MAINTAIN PEDESTRIAN ACCESS ON ONE SIDE AT ALL TIMES.
6. TC-2 ROADWORK SIGNAGE TO BE PLACED 50.0m IN ADVANCE OF CONSTRUCTION.

CONSTRUCTION AREA:

FOR INFORMATION ONLY

TENDER NO. 11-2023



**THE CITY OF WINNIPEG**  
PUBLIC WORKS DEPARTMENT

**BALMORAL ST**  
FROM ELICE AVE TO 120m NORTH  
TEMPORARY TRAFFIC SIGNAGE

ENGINEERING DIVISION  
TECHNOLOGY SERVICES BRANCH  
106 - 1155 PACIFIC AVE

SOUTH SIDE - PHASE I - TEMPORARY TRAFFIC SIGNAGE DETAIL 'A'

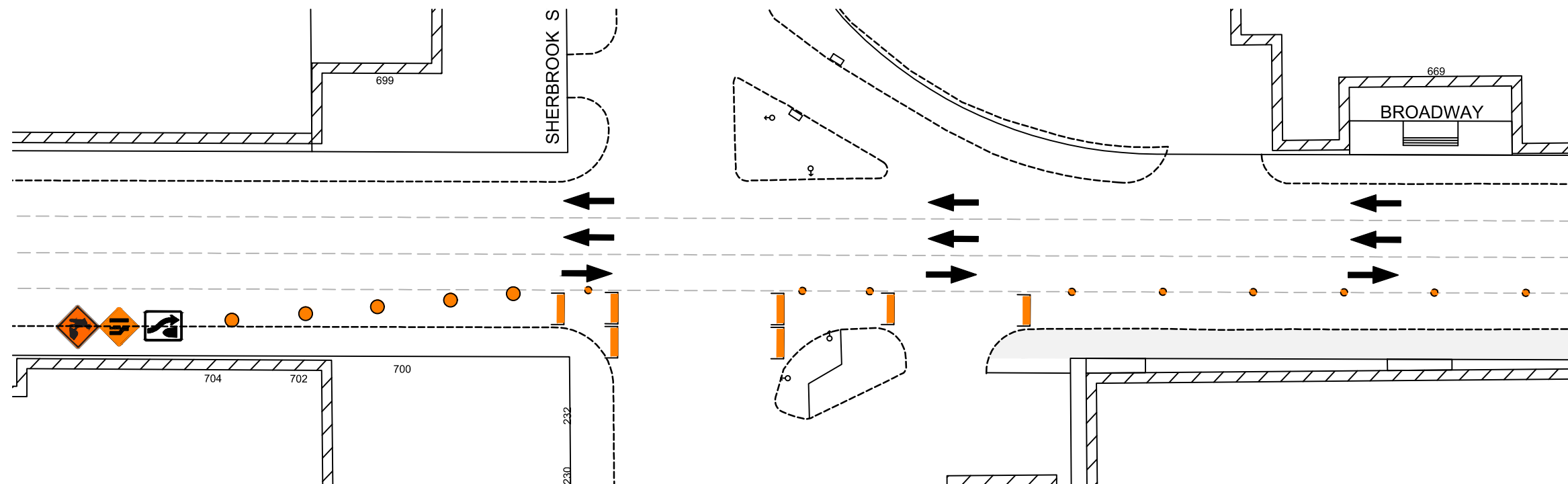

SOUTH SIDE - PHASE I - TEMPORARY TRAFFIC SIGNAGE DETAIL 'B'

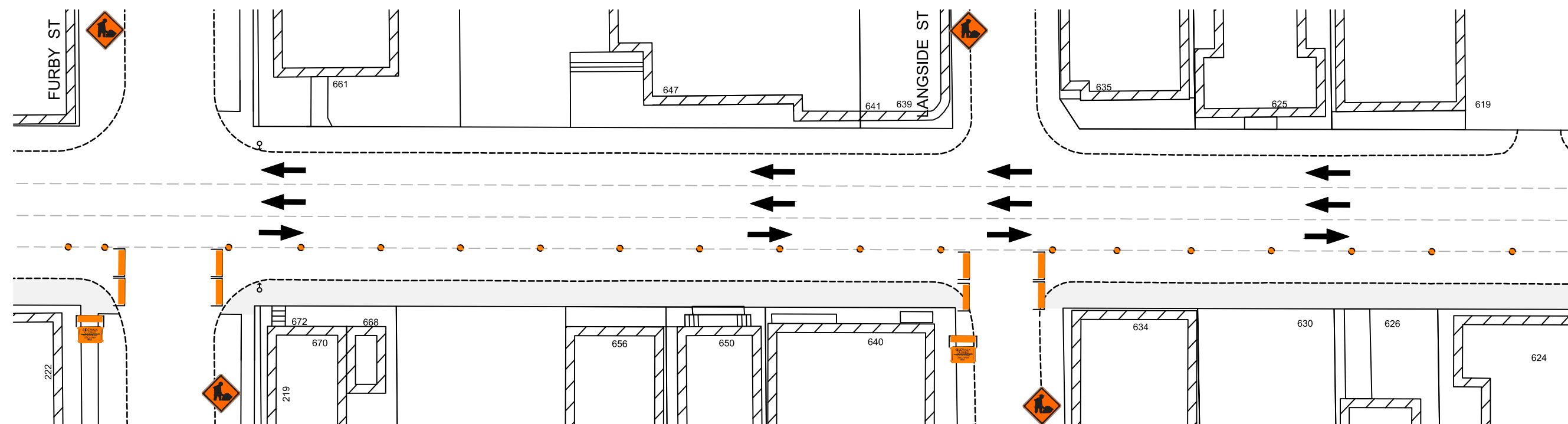

TRAFFIC SIGNAGE & STAGING

- TC-2 ROADWORK
- CHEVRON LEFT/RIGHT
- RB 11 (L/R) TURN PROHIBITED
- RB 25(L) KEEP LEFT/RIGHT
- BARRICADE
- CHANNELIZATION BARREL



- TRAFFIC LANE DIRECTION
- POLY POST
- YIELD TO ONCOMING TRAFFIC
- C-46 SIDEWALK CLOSED
- FLAGMAN
- TC-5R RIGHT LANE ENDS



NOTES:

1. ALL TRAFFIC SIGNAGE AND TEMPORARY TRAFFIC CONTROL TO CONFORM WITH THE LATEST REVISION OF THE CITY OF WINNIPEG MANUAL OF TEMPORARY TRAFFIC CONTROL ON CITY STREETS
2. ONE LANE MUST REMAIN OPEN DURING CONSTRUCTION
3. PEDESTRIAN CORRIDOR MUST BE MAINTAINED IN THE CURB LANES DURING CONSTRUCTION IF THE SIDEWALK HAS BEEN REMOVED, AND THERE MUST BE ACCESS PROVIDED TO ALL RESIDENCES AND BUSINESSES
4. PARKING TO BE REMOVED AT TIME OF CONSTRUCTION.
5. CONTRACTOR SHALL MAINTAIN SAFE PEDESTRIAN ACCESS AND CROSSINGS. WHERE SIDEWALKS ARE LOCATED ON BOTH SIDES OF THE STREET, CONTRACTOR MUST MAINTAIN PEDESTRIAN ACCESS ON ONE SIDE AT ALL TIMES.
6. TC-2 ROADWORK SIGNAGE TO BE PLACED 50.0m IN ADVANCE OF CONSTRUCTION.

CONSTRUCTION AREA: \_\_\_\_\_

FOR INFORMATION ONLY

TENDER NO. 11-2023



THE CITY OF WINNIPEG  
PUBLIC WORKS DEPARTMENT

ENGINEERING DIVISION  
TECHNOLOGY SERVICES BRANCH  
106 - 1155 PACIFIC AVE

**BROADWAY**  
FROM SHERBROOK ST TO SPENCE ST  
TEMPORARY TRAFFIC SIGNAGE

SOUTH SIDE - PHASE I - TEMPORARY TRAFFIC SIGNAGE DETAIL 'C'

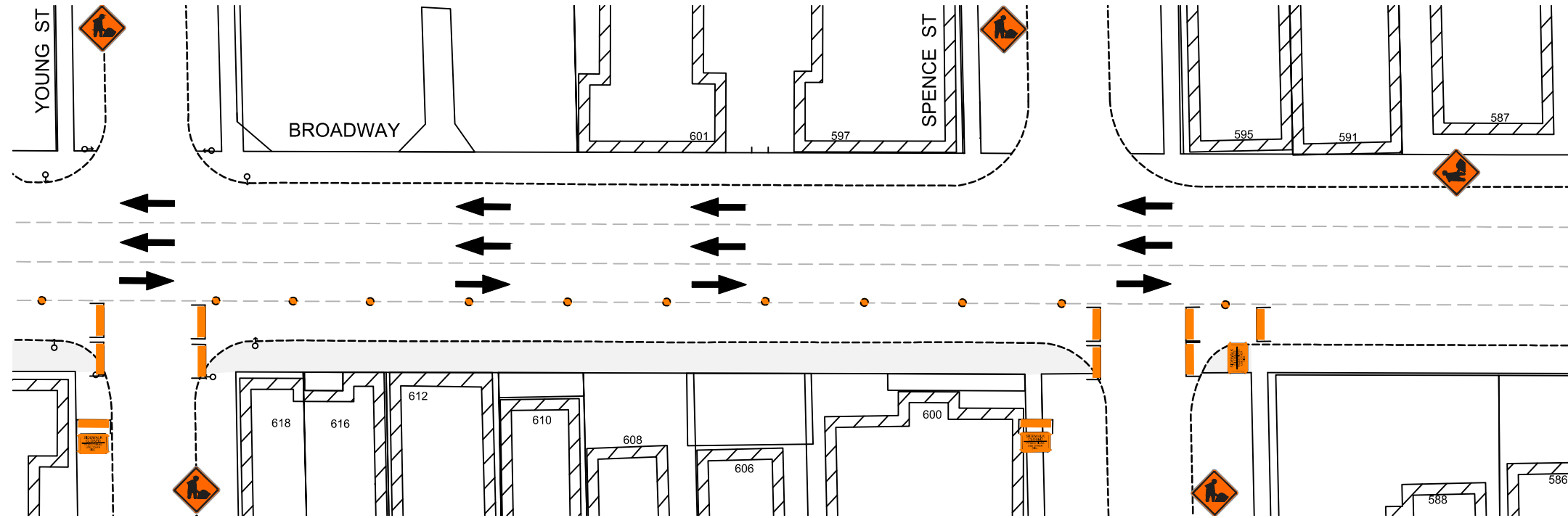

TRAFFIC SIGNAGE & STAGING

- TC-2 ROADWORK
- CHEVRON LEFT/RIGHT
- RB 11 (L/R) TURN PROHIBITED
- RB 25(L) KEEP LEFT/RIGHT
- BARRICADE
- CHANNELIZATION BARREL



- TRAFFIC LANE DIRECTION
- POLY POST
- YIELD TO ONCOMING TRAFFIC
- C-46 SIDEWALK CLOSED
- FLAGMAN
- TC-5R RIGHT LANE ENDS



NOTES:

1. ALL TRAFFIC SIGNAGE AND TEMPORARY TRAFFIC CONTROL TO CONFORM WITH THE LATEST REVISION OF THE CITY OF WINNIPEG MANUAL OF TEMPORARY TRAFFIC CONTROL ON CITY STREETS
2. ONE LANE MUST REMAIN OPEN DURING CONSTRUCTION
3. PEDESTRIAN CORRIDOR MUST BE MAINTAINED IN THE CURB LANES DURING CONSTRUCTION IF THE SIDEWALK HAS BEEN REMOVED, AND THERE MUST BE ACCESS PROVIDED TO ALL RESIDENCES AND BUSINESSES
4. PARKING TO BE REMOVED AT TIME OF CONSTRUCTION.
5. CONTRACTOR SHALL MAINTAIN SAFE PEDESTRIAN ACCESS AND CROSSINGS. WHERE SIDEWALKS ARE LOCATED ON BOTH SIDES OF THE STREET, CONTRACTOR MUST MAINTAIN PEDESTRIAN ACCESS ON ONE SIDE AT ALL TIMES.
6. TC-2 ROADWORK SIGNAGE TO BE PLACED 50.0m IN ADVANCE OF CONSTRUCTION.

CONSTRUCTION AREA:

FOR INFORMATION ONLY

TENDER NO. 11-2023



**THE CITY OF WINNIPEG**  
PUBLIC WORKS DEPARTMENT

ENGINEERING DIVISION  
TECHNOLOGY SERVICES BRANCH  
106 - 1155 PACIFIC AVE

**BROADWAY**  
FROM SHERBROOK ST TO SPENCE ST  
TEMPORARY TRAFFIC SIGNAGE

NORTH SIDE - PHASE II - TEMPORARY TRAFFIC SIGNAGE DETAIL 'A'

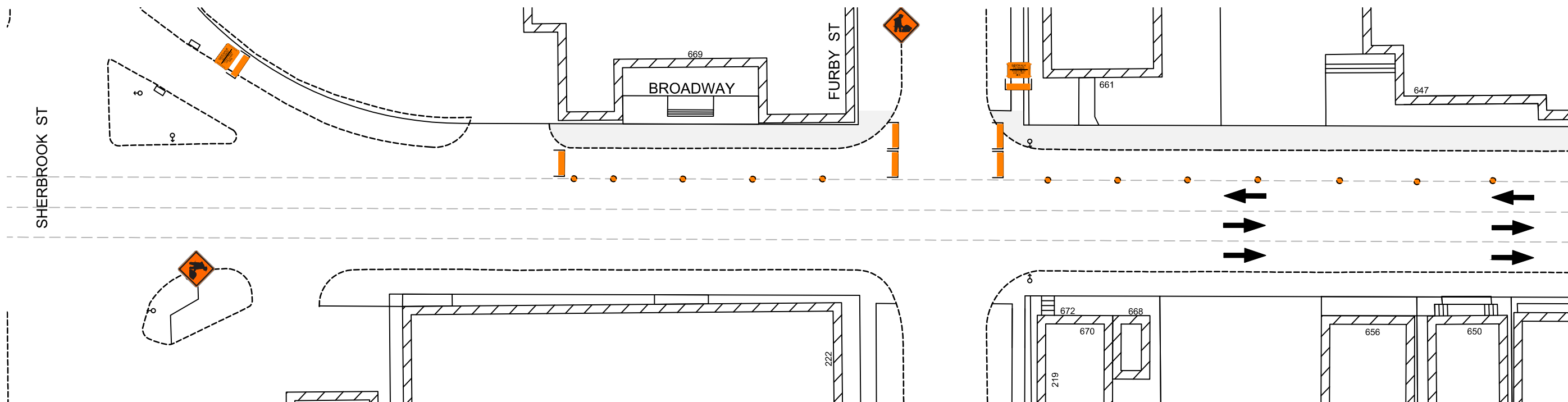

NORTH SIDE - PHASE II - TEMPORARY TRAFFIC SIGNAGE DETAIL 'B'

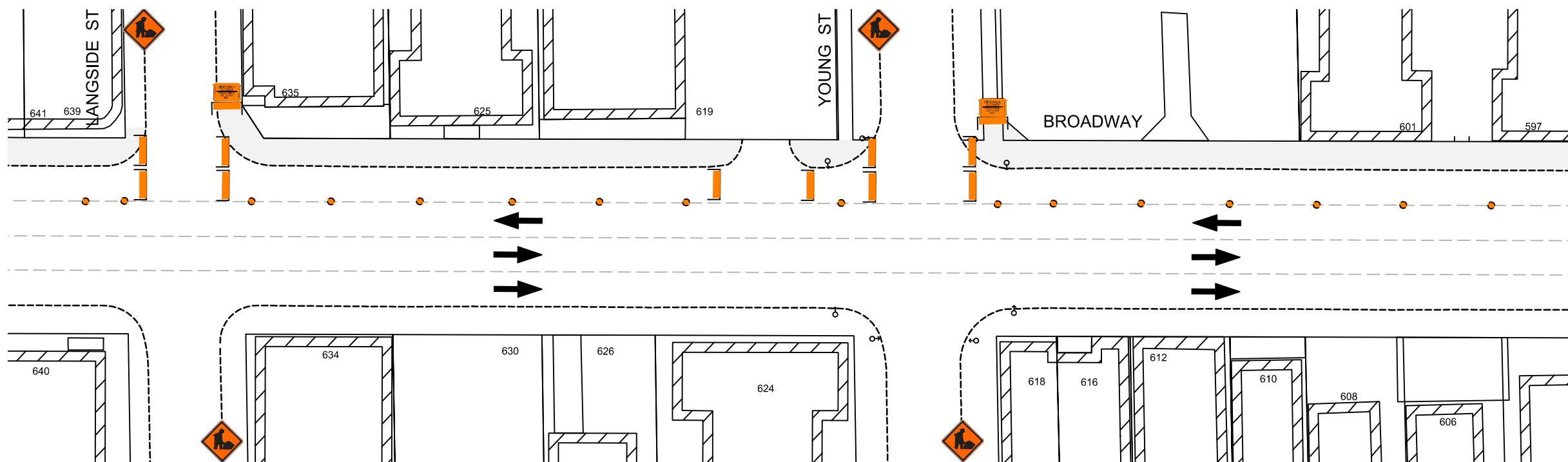

TRAFFIC SIGNAGE & STAGING

- TC-2 ROADWORK
- CHEVRON LEFT/RIGHT
- RB 11 (L/R) TURN PROHIBITED
- RB 25(L) KEEP LEFT/RIGHT
- BARRICADE
- CHANNELIZATION BARREL



- TRAFFIC LANE DIRECTION
- POLY POST
- YIELD TO ONCOMING TRAFFIC
- C-46 SIDEWALK CLOSED
- FLAGMAN
- TC-5R RIGHT LANE ENDS



NOTES:

1. ALL TRAFFIC SIGNAGE AND TEMPORARY TRAFFIC CONTROL TO CONFORM WITH THE LATEST REVISION OF THE CITY OF WINNIPEG MANUAL OF TEMPORARY TRAFFIC CONTROL ON CITY STREETS
2. ONE LANE MUST REMAIN OPEN DURING CONSTRUCTION
3. PEDESTRIAN CORRIDOR MUST BE MAINTAINED IN THE CURB LANES DURING CONSTRUCTION IF THE SIDEWALK HAS BEEN REMOVED, AND THERE MUST BE ACCESS PROVIDED TO ALL RESIDENCES AND BUSINESSES
4. PARKING TO BE REMOVED AT TIME OF CONSTRUCTION.
5. CONTRACTOR SHALL MAINTAIN SAFE PEDESTRIAN ACCESS AND CROSSINGS. WHERE SIDEWALKS ARE LOCATED ON BOTH SIDES OF THE STREET, CONTRACTOR MUST MAINTAIN PEDESTRIAN ACCESS ON ONE SIDE AT ALL TIMES.
6. TC-2 ROADWORK SIGNAGE TO BE PLACED 50.0m IN ADVANCE OF CONSTRUCTION.

CONSTRUCTION AREA: \_\_\_\_\_

FOR INFORMATION ONLY

TENDER NO. 11-2023



THE CITY OF WINNIPEG  
PUBLIC WORKS DEPARTMENT

ENGINEERING DIVISION  
TECHNOLOGY SERVICES BRANCH  
106 - 1155 PACIFIC AVE

**BROADWAY**  
FROM SHERBROOK ST TO SPENCE ST  
TEMPORARY TRAFFIC SIGNAGE



NORTH SIDE - PHASE II - TEMPORARY TRAFFIC SIGNAGE DETAIL 'C'

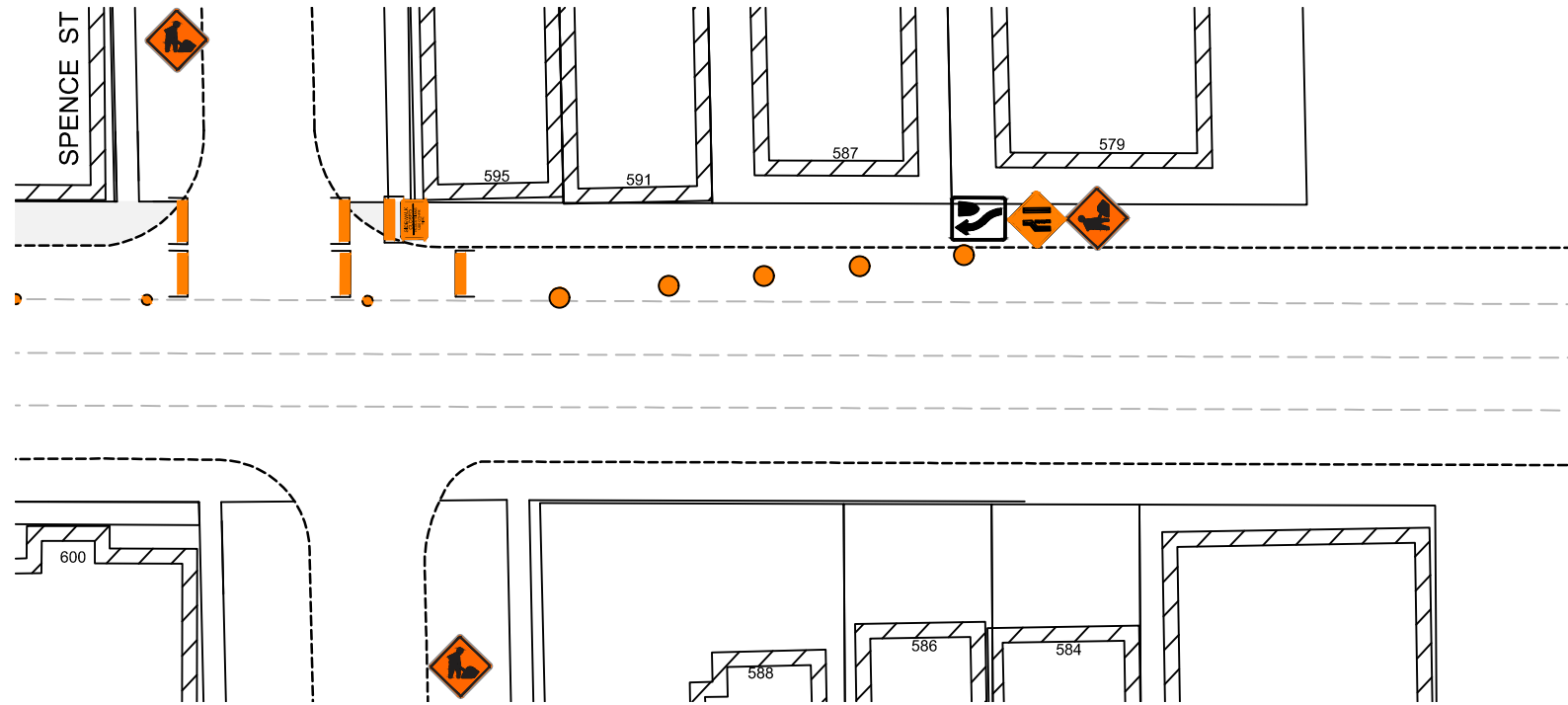

TRAFFIC SIGNAGE & STAGING

- TC-2 ROADWORK
- CHEVRON LEFT/RIGHT
- RB 11 (L/R) TURN PROHIBITED
- RB 25(L) KEEP LEFT/RIGHT
- BARRICADE
- CHANNELIZATION BARREL



- TRAFFIC LANE DIRECTION
- POLY POST
- YIELD TO ONCOMING TRAFFIC
- C-46 SIDEWALK CLOSED
- FLAGMAN
- TC-5R RIGHT LANE ENDS



NOTES:

1. ALL TRAFFIC SIGNAGE AND TEMPORARY TRAFFIC CONTROL TO CONFORM WITH THE LATEST REVISION OF THE CITY OF WINNIPEG MANUAL OF TEMPORARY TRAFFIC CONTROL ON CITY STREETS
2. ONE LANE MUST REMAIN OPEN DURING CONSTRUCTION
3. PEDESTRIAN CORRIDOR MUST BE MAINTAINED IN THE CURB LANES DURING CONSTRUCTION IF THE SIDEWALK HAS BEEN REMOVED, AND THERE MUST BE ACCESS PROVIDED TO ALL RESIDENCES AND BUSINESSES
4. PARKING TO BE REMOVED AT TIME OF CONSTRUCTION.
5. CONTRACTOR SHALL MAINTAIN SAFE PEDESTRIAN ACCESS AND CROSSINGS. WHERE SIDEWALKS ARE LOCATED ON BOTH SIDES OF THE STREET, CONTRACTOR MUST MAINTAIN PEDESTRIAN ACCESS ON ONE SIDE AT ALL TIMES.
6. TC-2 ROADWORK SIGNAGE TO BE PLACED 50.0m IN ADVANCE OF CONSTRUCTION.

CONSTRUCTION AREA:

FOR INFORMATION ONLY

TENDER NO. 11-2023



THE CITY OF WINNIPEG  
PUBLIC WORKS DEPARTMENT





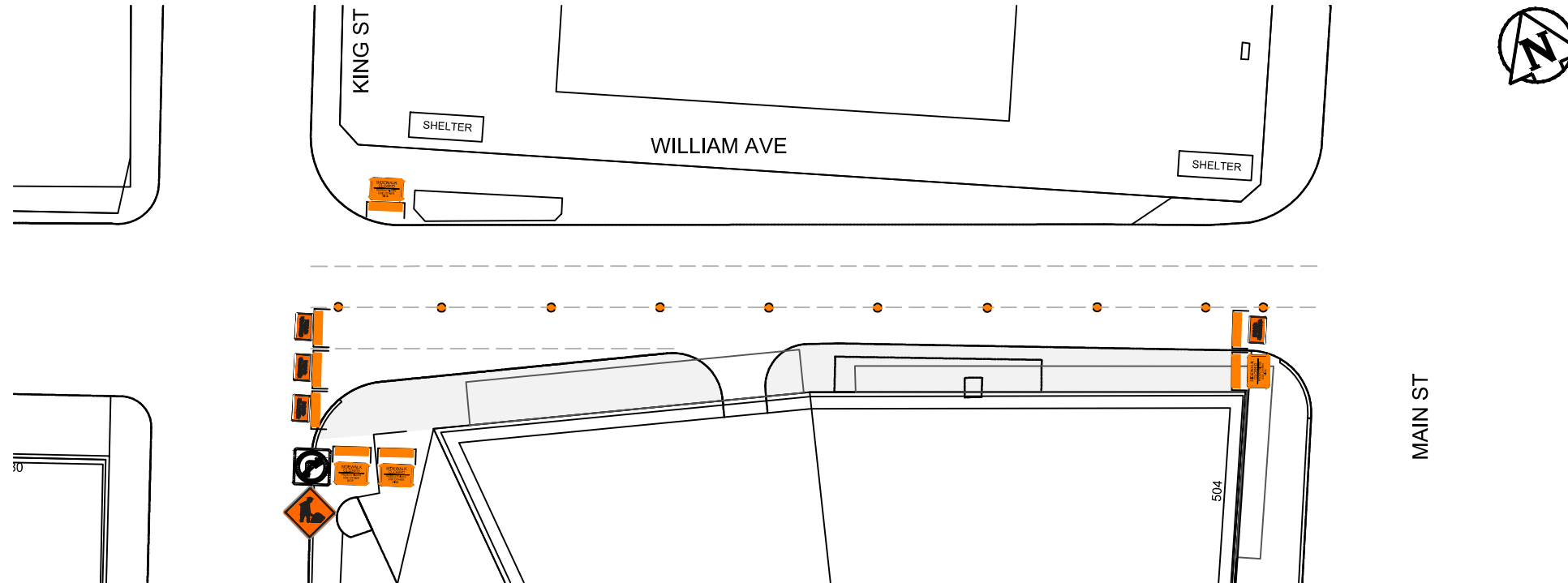

ENGINEERING DIVISION  
TECHNOLOGY SERVICES BRANCH  
106 - 1155 PACIFIC AVE

**BROADWAY**  
FROM SHERBROOK ST TO SPENCE ST  
TEMPORARY TRAFFIC SIGNAGE



**TRAFFIC SIGNAGE & STAGING**

- TC-2 ROADWORK 
- CHEVRON LEFT/RIGHT 
- RB 11 (L/R) TURN PROHIBITED 
- RB 25(L) KEEP LEFT/RIGHT 
- BARRICADE 
- CHANNELIZATION BARREL 

- TRAFFIC LANE DIRECTION 
- POLY POST 
- YIELD TO ONCOMING TRAFFIC 
- C-46 SIDEWALK CLOSED 
- FLAGMAN 
- TC-5R RIGHT LANE ENDS 

- NOTES:**
1. ALL TRAFFIC SIGNAGE AND TEMPORARY TRAFFIC CONTROL TO CONFORM WITH THE LATEST REVISION OF THE CITY OF WINNIPEG MANUAL OF TEMPORARY TRAFFIC CONTROL ON CITY STREETS
  2. ONE LANE MUST REMAIN OPEN DURING CONSTRUCTION
  3. PEDESTRIAN CORRIDOR MUST BE MAINTAINED IN THE CURB LANES DURING CONSTRUCTION IF THE SIDEWALK HAS BEEN REMOVED, AND THERE MUST BE ACCESS PROVIDED TO ALL RESIDENCES AND BUSINESSES
  4. PARKING TO BE REMOVED AT TIME OF CONSTRUCTION.
  5. CONTRACTOR SHALL MAINTAIN SAFE PEDESTRIAN ACCESS AND CROSSINGS. WHERE SIDEWALKS ARE LOCATED ON BOTH SIDES OF THE STREET, CONTRACTOR MUST MAINTAIN PEDESTRIAN ACCESS ON ONE SIDE AT ALL TIMES.
  6. TC-2 ROADWORK SIGNAGE TO BE PLACED 50.0m IN ADVANCE OF CONSTRUCTION.

CONSTRUCTION AREA:

ENGINEERING DIVISION  
TECHNOLOGY SERVICES BRANCH  
106 - 1155 PACIFIC AVE

FOR INFORMATION ONLY TENDER NO. 11-2023



**THE CITY OF WINNIPEG**  
PUBLIC WORKS DEPARTMENT

**WILLIAM AVE**  
FROM KING ST TO MAIN ST  
TEMPORARY TRAFFIC SIGNAGE



TEMPORARY TRAFFIC SIGNAGE DETAIL 'A'

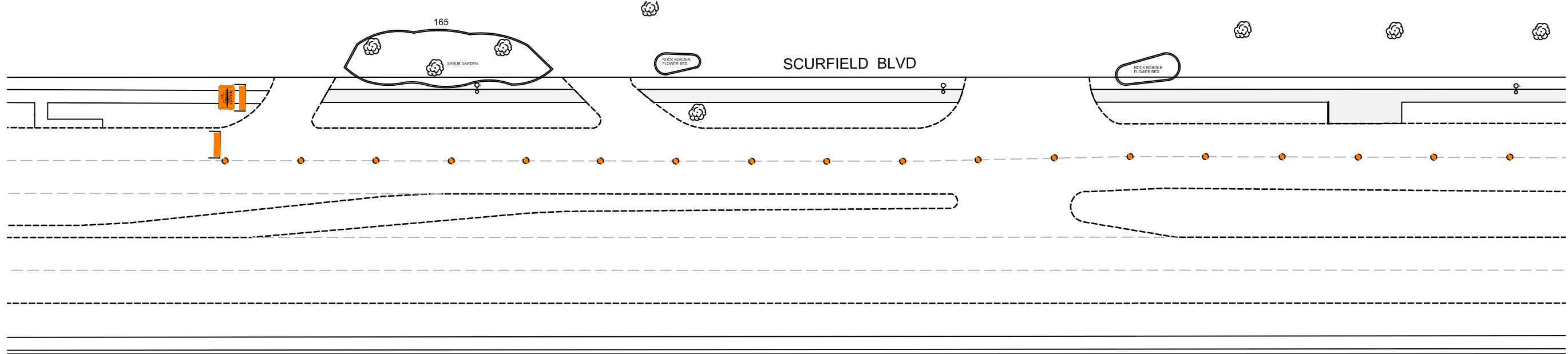

TEMPORARY TRAFFIC SIGNAGE DETAIL 'B'

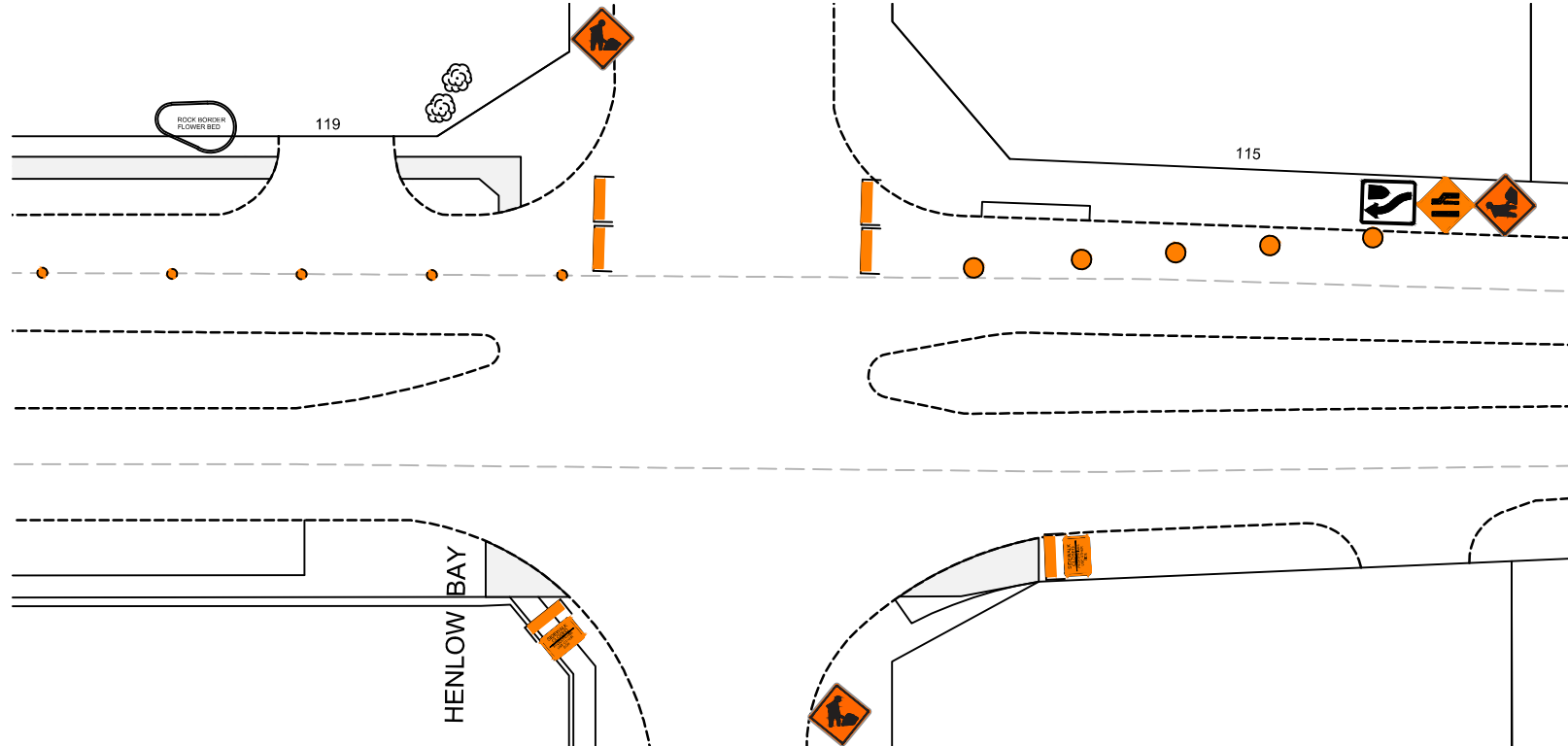

TRAFFIC SIGNAGE & STAGING

TC-2 ROADWORK		TRAFFIC LANE DIRECTION	
CHEVRON LEFT/RIGHT		POLY POST	
RB 11 (L/R) TURN PROHIBITED		YIELD TO ONCOMING TRAFFIC	
RB 25(L) KEEP LEFT/RIGHT		C-46 SIDEWALK CLOSED	
BARRICADE		FLAGMAN	
CHANNELIZATION BARREL		TC-5R RIGHT LANE ENDS	

NOTES:

1. ALL TRAFFIC SIGNAGE AND TEMPORARY TRAFFIC CONTROL TO CONFORM WITH THE LATEST REVISION OF THE CITY OF WINNIPEG MANUAL OF TEMPORARY TRAFFIC CONTROL ON CITY STREETS
2. ONE LANE MUST REMAIN OPEN DURING CONSTRUCTION
3. PEDESTRIAN CORRIDOR MUST BE MAINTAINED IN THE CURB LANES DURING CONSTRUCTION IF THE SIDEWALK HAS BEEN REMOVED, AND THERE MUST BE ACCESS PROVIDED TO ALL RESIDENCES AND BUSINESSES
4. PARKING TO BE REMOVED AT TIME OF CONSTRUCTION.
5. CONTRACTOR SHALL MAINTAIN SAFE PEDESTRIAN ACCESS AND CROSSINGS. WHERE SIDEWALKS ARE LOCATED ON BOTH SIDES OF THE STREET, CONTRACTOR MUST MAINTAIN PEDESTRIAN ACCESS ON ONE SIDE AT ALL TIMES.
6. TC-2 ROADWORK SIGNAGE TO BE PLACED 50.0m IN ADVANCE OF CONSTRUCTION.

CONSTRUCTION AREA:

FOR INFORMATION ONLY

TENDER NO. 11-2023



**THE CITY OF WINNIPEG**  
PUBLIC WORKS DEPARTMENT

ENGINEERING DIVISION  
TECHNOLOGY SERVICES BRANCH  
106 - 1155 PACIFIC AVE

**SCURFIELD BLVD**  
FROM 70m EAST OF KENASTON BLVD TO HENLOW BAY WEST LEG  
TEMPORARY TRAFFIC SIGNAGE